

NHS Lothian R&D Conference 2025

The Evolving Landscape of Clinical Research in NHS Lothian

DELEGATE BOOKLET

Thursday 22 May 2025,
John McIntyre Conference Centre, Edinburgh

General information

Meeting venue

John McIntyre Conference Centre,
Pollock Halls
18 Holyrood Park Road
Edinburgh
EH16 5AY

Getting to the venue

For a map and directions to the venue, please visit [the University of Edinburgh Conferences and events website](#).

Parking information

Please note that on-site parking is limited and runs on a first come-first served basis.

At the gatehouse entrance, please inform security that you are attending the NHS Lothian R&D Conference 2025.

Alternative [car park facilities are on St Leonard's Street](#) if on site car parking is full.

Access requirements

Please [email Edinburgh Clinical Research Facilities \(CRF\)](#) if you have not already informed us of any access requirements for the meeting, e.g. physical access, hearing loop etc.

Registration

The registration desk will open in the John McIntyre Centre from:

- 9am on Thursday 22 May 2025

On arrival, attendees will be given a name badge to wear for the duration of the event. For health and safety purposes, all attendees are requested to sign in.

Catering and Refreshments

Catering and refreshments will be provided during day.

The John McIntyre Centre will have been informed of dietary requirements specified on the registration forms. If you have specified a dietary requirement, please make yourself known to a member of the catering staff during refreshment breaks.

If you have any dietary requirement that you have not already informed us about, please [email Edinburgh Clinical Research Facilities \(CRF\)](#).

Food statement from the venue

We would like to make you aware that we cannot eliminate or guarantee that cross contamination of food items will not happen, from within our kitchens or on food service stations.

Whilst we make every effort to limit contamination, and to accommodate dietary preferences and food intolerances (allergen specific, vegan or vegetarian) across our menu portfolio, our food may have come into contact with other food items and several allergens such as dairy, eggs, nuts or shellfish.

For those with severe allergies or food intolerances, we advise it may be best to consider providing your own food options.

Our Wellbeing Portals display an allergen profile for each menu item, with additional dietary information such as nutrition, ingredients and calories to help customers make safe and informed choices:

[Visit our Conferences and Events portal website for more information.](#)

Wi-Fi Access

Wi-Fi at the centre is through 'Visit-Ed' network. To connect, search for this network on your device, fill in your name, email address and tick to agree with the terms and conditions. You will not require a password.

For those already with access, the Wi-Fi network 'Eduroam' is also available within the venue.

Remember to use the hashtag #2025R&DConf on Bluesky!

Photographs

Please note we will be taking pictures throughout the two days for marketing purposes. Individuals wearing red lanyards have requested not to be included in any photographs. Please speak to a member of the administration team at reception if you have any concerns.

Local Taxi phone numbers

- Capital Cars – 0131 777 7777
- Central Taxis – 0131 229 2468
- City Cabs – 0131 228 1211

Map - John McIntyre Conference Centre

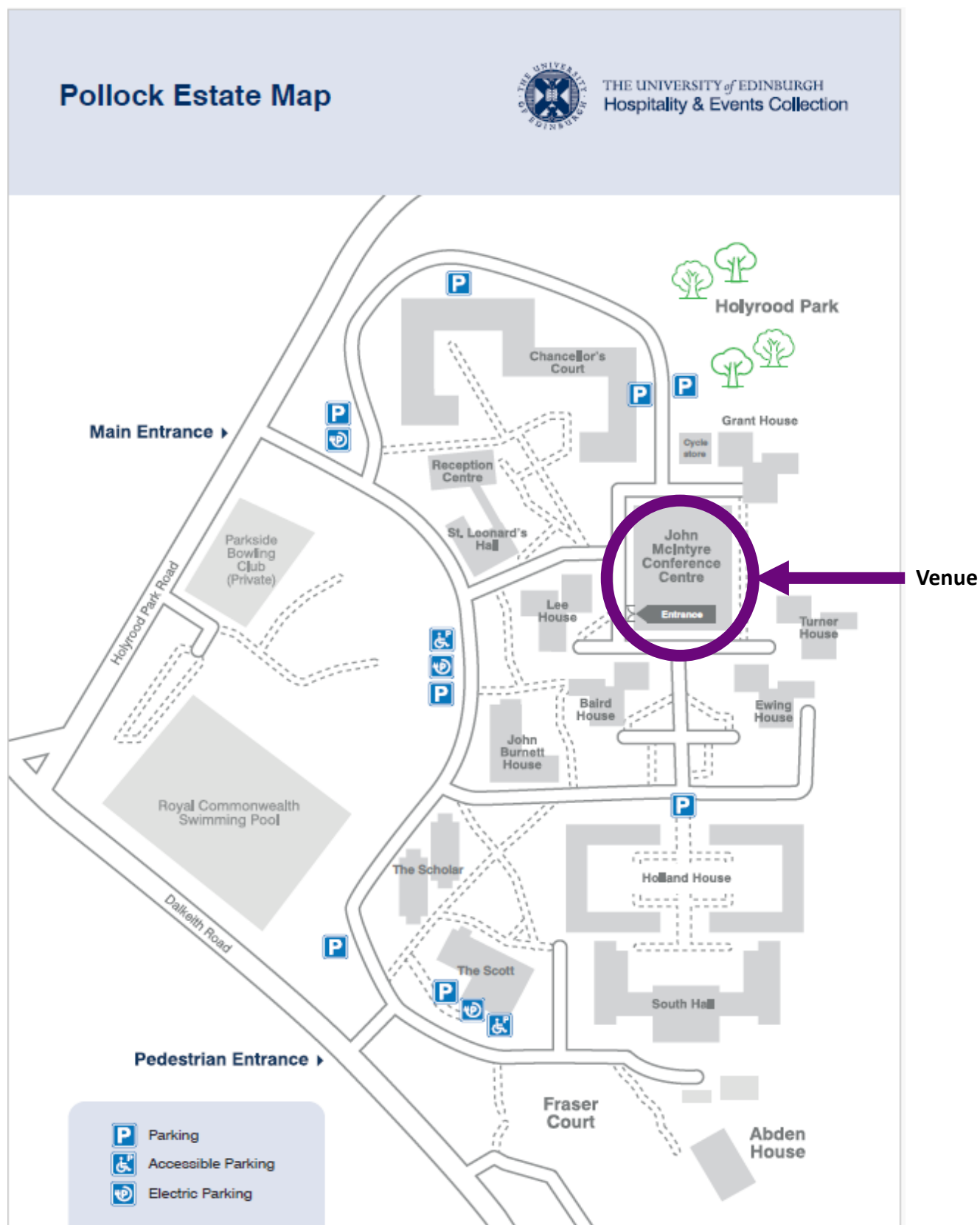

Floor Plan - John McIntyre Conference Centre

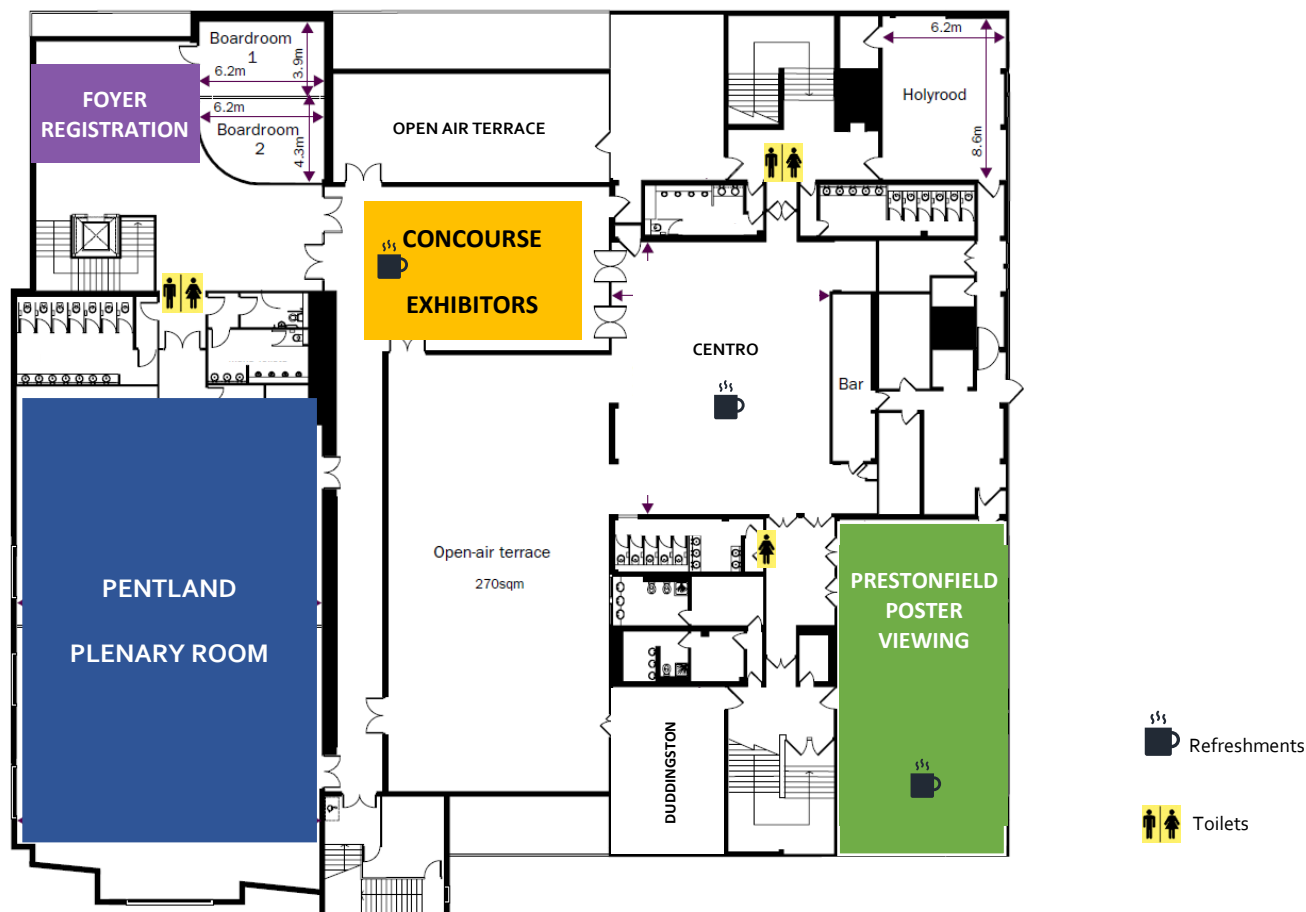

Conference Programme

09:00 - 09:30		Registration and refreshments	
Session 1		THE FUTURE OF CLINICAL RESEARCH AND INNOVATION IN NHS Lothian AND SCOTLAND Chair: Tracey Gillies	
09:30 - 09:40	Welcome	Professor Alasdair Gray	
09:40 - 10:00	The value of research to NHS Lothian	Professor Caroline Hiscox	
10:00 - 10:20	Research enabled innovation: pathway to adoption	Professor Dame Anna Dominiczak	
10:20 - 10:40	The impact of genomic research on health care	Professor Kenneth Baillie	
10:40 - 11:00	High impact trials 1 – The EVOLVED trial	Professor Marc Dweck	
11:00 - 11:30		Refreshments, networking and poster viewing	
Session 2		THE VALUE OF COLLABORATION WITH INDUSTRY	Chair: Professor David Newby
11.30 - 11.45	Cancer trials and industry collaboration	Dr Stefan Symeonides	
11.45 - 12.00	Artificial Intelligence – tools to support diagnostics	Professor Michelle Williams	
12.00 - 12.15	Vaccine trials and industry collaboration	Dr Rebecca Sutherland	
12.15 - 12.30	High impact trials 2 – the ALLEGRO trial	Mr Hugh Paterson	
12.30 - 13.30		Lunch, networking and poster viewing	
Session 3 (13.30-14.30)		RESEARCH SHOWCASE: PRESENTATIONS FROM SELECTED ABSTRACT SUBMISSIONS Chair: Professor Sarah Walmsley	
1.	Revealing maternal vascular responses to pregnancy through the eye	Dr Kathryn Hunt	
2.	Treating drug overdose-related coma with intramuscular (IM) flumazenil: the RUFUS Study	Professor Michael Eddleston	
3.	Harnessing Machine Learning to forecast inpatient care intensity for unscheduled admissions in NHS Lothian	Mr Konstantin Georgiev	
4.	Patient stratification identifies differential treatment effects in Staphylococcus aureus bacteraemia	Dr Clark Russell	
5.	A randomised controlled trial of homemade hypertonic saline nose drops to treat children with upper respiratory tract infection: ELVIS-Kids	Dr Sandeep Ramalingam	
14.30 - 15.00		Refreshments, networking and poster viewing	
Session 4		ADVANCED THERAPIES	Chair: Scott Garden
15.00 - 15.15	Advanced therapy treatment centres	Professor Marc Turner	
15.15 - 15.30	Advanced therapy trials in haematology	Dr Victoria Campbell	
15.30 - 15.45	Advanced therapy trials in paediatric neurology	Dr Jay Shetty	
15.45 - 16.00	MND SMART: A UK platform for flexible, efficient and definitive MND trials	Professor Suvankar Pal	
16.00 - 16.05	Closing remarks and poster prizes	Professor Alasdair Gray	

Conference speakers

Professor Alasdair Gray

R&I Director, ACCORD, NHS Lothian



Professor Alasdair Gray is the Director of research and innovation in NHS Lothian and has been a consultant in the Emergency department at the Royal Infirmary since 2001. He has been the research lead for the Royal College of Emergency Medicine, UK and is a member of the research group, [EMERGE](#). He has over two decades experience in the leadership and delivery of pragmatic randomised trials in emergency care including the 3CPO, 3MG, RAPID-CTCA and ABC Sepsis trials.

Professor Caroline Hiscox

Chief Executive, NHS Lothian



Caroline is the Chief Executive of NHS Lothian and has significant and demonstrable leadership experience at an executive leadership level in NHS Scotland. Her professional experience as a Registered Nurse and core values means that she has an unwavering focus on optimising the potential of people with a particular interest in organisational cultures, accountability and leadership in complex systems.

As a senior leader in Scotland's health and care system, Caroline is deeply aware of the impact that her leadership attitude, language and behaviour has on people, and on the culture of the organisations she leads. With this understanding, Caroline describes her leadership style as "collaborative, honest and human...always keeping it real, listening and acknowledging imperfection".

This approach has allowed Caroline to push the boundaries of the traditional expectations of the NHS Chief Executive role by positioning herself robustly as a system leader influencing across professional, organisational and political perspectives to create the conditions for ambitious whole system changes designed around people and good health rather than services and ill health.

Title of session: [The value of research to NHS Lothian](#)

**Professor Dame
Anna Dominiczak**



**Regius Chair of Medicine and Chief Scientific Advisor
(Health), School of Cardiovascular and Metabolic Health,
University of Glasgow and the Scottish Government**

Professor Dominiczak is a world-leading cardiovascular scientist and clinical academic. She has published extensively in top peer-reviewed journals (over 550 publications, a h-index of 123 according to Web of Science). Between 2010 and 2020 she was Vice-Principal and Head of the College of Medical, Veterinary and Life Sciences at the University of Glasgow. She was the driving force behind the fundraising, development and delivery of the University's clinical academic campus at the Queen Elizabeth University Hospital, where she led a triple helix partnership between academia, the NHS, and industry to accelerate innovation, maximize patient benefits and economic growth.

Dame Anna is a member of several editorial boards and, from 2012 - 2022, was Editor-in-Chief of Hypertension, journal of the American Heart Association. Currently, she is Editor-in Chief of Precision Medicine, a new prism journal of the Cambridge press.

In March 2020, Anna led the establishment of Lighthouse Laboratory in Glasgow to provide rapid Covid-19 diagnostics, and then was asked to become Director of Laboratories at the UK department of Health and Social Care to lead all 10 Lighthouse Laboratories across the UK, the role she fulfilled until 2022.

In July 2022 Professor Dominiczak was appointed as Chief Scientific Advisor (Health) for the Scottish Government, where she leads and coordinates health research and innovation, working in partnership with the NHS, academia and industry to develop rapid translation and adoption of transformative innovations for the Scottish NHS.

Title of session: 'Research enabled innovation: pathway to adoption'

Professor J Kenneth Baillie

**Professor of Experimental Medicine and Consultant in
Intensive Care Medicine,
Baillie Gifford Pandemic Science Hub,
University of Edinburgh**

Kenny graduated from the University of Edinburgh with a BSc (Hons) in Physiology in 1999 and MBChB in 2002. He completed basic training in medicine in Glasgow, and in anaesthesia in Edinburgh. During this time, he led a series of high-altitude research projects in Bolivia, and founded a high-altitude research charity, Apex. He was appointed as a clinical lecturer on the ECAT (Edinburgh Clinical Academic Track) at the University of Edinburgh in 2008 and completed a Wellcome Trust-funded PhD in statistical genetics in 2012. He was awarded a Wellcome-Beit Prize Intermediate Clinical Fellowship in 2013. He led a global consensus on harmonisation of research studies in outbreaks for the International Severe Acute Respiratory Infection Consortium (ISARIC), and worked with WHO on H1N1 influenza, MERS, and Ebola. After completing clinical training in 2014 he worked as a visiting scientist at the Broad Institute of Harvard and MIT, before returning to the Roslin Institute, University of Edinburgh to establish a research program in translational applications of genomics in critical care medicine. He works as a consultant in the intensive care unit at the Royal Infirmary, Edinburgh. During the Covid-19 outbreak in 2020-21, he led the UK-wide GenOMICC and ISARIC4C studies, and contributed to the design and delivery of the RECOVERY trial. He discovered new biological mechanisms underlying critical illness in Covid and contributed to the discovery of effective drug treatments to reduce mortality. He leads a research programme in translational genomics - using genetic signals from critically ill patients to identify both the targets for drug therapy, and the groups of patients likely to benefit most from any treatment and testing those therapeutic ideas in highly efficient model systems.

Title of session: [The impact of genomic research on health care](#)

Professor Marc Dweck



Professor of Clinical Cardiology and Consultant Cardiologist, Cardiology, University of Edinburgh

Professor Marc Dweck is the Chair of Clinical Cardiology at the University of Edinburgh, a British Heart Foundation Senior Clinical Research Fellow and a Consultant Cardiologist at the Royal Infirmary of Edinburgh. His research program uses multi-modality imaging to advance our understanding of cardiovascular disease and to improve patient care (>450 manuscripts, H-index 85). He is Vice-President of the European Association of Cardiovascular Imaging (EACVI), Chair of the ESC/EACVI Committee for CT accreditation and Chair of the BHF/NIHR Partnership Working Group for Heart Valve Disease.

Title of session: [High impact trials 1: The EVOLVED trial](#)

Dr Stefan Symeonides



Senior Clinical Lecturer in experimental cancer medicine / Consultant Medical Oncologist, Oncology, University of Edinburgh

Stefan Symeonides is a Consultant Medical Oncologist and Senior Clinical Lecturer at the Institute of Genetics and Cancer (University of Edinburgh) and at the linked Edinburgh Cancer Centre (NHS Lothian) and CRUK Scotland Centre (Universities of Glasgow and Edinburgh); he also has a pharmaceutical medicine role at Cancer Research UK's Centre for Drug Development (CDD, London, UK), is on the board of directors of the non-profit organisation The Cancer Drug Development Forum (CDDF, Belgium), and has scientific advisory board roles with a number of oncology pharmaceutical companies and biotechs. After clinical training in the UK (Cambridge, Edinburgh), Australia (Melbourne) and New Zealand (Christchurch), and research in academia, clinic and industry, he now leads the Edinburgh Experimental Cancer Medicine Centre, where he provides the link between Edinburgh's laboratory discoveries and their clinical development. In the clinic, he leads the Edinburgh phase I cancer trials unit and recently stepped down from a specialty interest in renal cancer to take on an increased medical lead role in CRUK's Centre for drug development. His research spans cytotoxic, small molecule, metabolic and even psychological therapies, but his

main focus is immunotherapies, where he is the clinical lead for the Edinburgh Cancer Immunology network.

Title of session: "Cancer trial and industry collaboration"

Professor Michelle Williams



**Professor of Cardiovascular Imaging,
British Heart Foundation Centre for research excellence,
University of Edinburgh**

Professor Michelle Williams is a Professor of Cardiovascular Imaging at the University of Edinburgh and Honorary Consultant Radiologist at NHS Lothian. She is Associate Director of the British Heart Foundation Data Science Centre and the Imaging theme lead. Her research centres around multi-modality non-invasive imaging of the heart and blood vessels, including using machine learning and other advanced analytic techniques. She is president of the British Society of Cardiovascular Imaging, member of the executive committee of the European Society of Cardiovascular Radiology, member of the Board of Directors of the Society of Cardiovascular Computed Tomography.

Title of session: Artificial Intelligence - tools to support diagnostics

Dr Rebecca Sutherland



Infection Consultant, Infectious Diseases, NHS Lothian

Rebecca qualified from Edinburgh Medical School in 1999 and has worked in Oxford and rural South Africa before returning to Scotland to take up a consultant post in Infection at NHS Lothian. She has been local PI for several academic and industry studies at the Clinical Infection Research Group, Edinburgh and has a special interest in vaccination, optimising antimicrobial treatment and functional HIV cure. She is a National Research Scotland clinician, is the devolved nations representative for the British Infection Association and sits on the Chief Scientist Officer's Agile Response Group with respect to vaccine research.

Title of session: Vaccine trials and industry collaboration

Mr Hugh Paterson



Clinical Senior Lecturer University of Edinburgh, Colorectal Surgery, University of Edinburgh

Mr Paterson returned to Western General Hospital as a Clinical Senior Lecturer in Colorectal Surgery in 2008.

After graduating from Aberdeen, he undertook basic surgical training in the West of Scotland followed by 2 years of research into injury-induced host immune responses at Brigham and Women's Hospital/Harvard Medical School in Boston. He completed higher surgical training with a colorectal interest in Edinburgh and a post-CCT fellowship in laparoscopic colorectal surgery in UCL St Luc, Brussels.

Hugh is the Chief Investigator of ALLEGRO, a £1.3million NIHR-HTA-funded UK multicentre RCT of perioperative IV lidocaine in minimally invasive colorectal surgery.

[Title of session: High impact trials 2- the ALLEGRO trial](#)

Professor Marc Turner

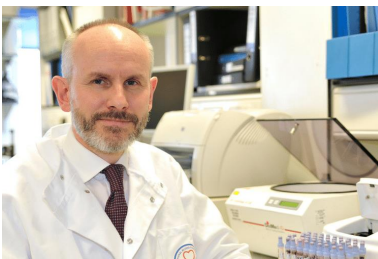

Director, Scottish National Blood Transfusion Service, National Services Scotland

Marc Turner is Director at the Scottish National Blood Transfusion Service and Professor of Cellular Therapy at the University of Edinburgh. He qualified in Medicine from the University of Manchester in 1982 and trained in General Medicine and Haematology. He obtained his PhD in human haematopoietic stem cell biology from the University of Edinburgh in 1995 and an MBA in Life Sciences from the Open University in 2007. He is a Fellow of the Royal College of Physicians of London, of the Royal College of Physicians of Edinburgh, of the Royal College of Pathologists and of the Royal Society of Edinburgh.

His research interests include the risk of transmission of prion diseases by blood, tissues and cells and the translation of advanced therapy medicinal products to clinical practice. He has held 40 research grants and has over 185 academic publications.

He is a Commissioner on the Commission on Human Medicines, a Member of the Scottish Medicines Consortium and the UK Advisory Committee on the Safety of Blood, Tissues and Organs and is Scotland Lead for the UK Advanced Therapy Treatment Centre Network.

[Title of session: Advanced therapy treatment centres](#)

Dr Victoria Campbell



Consultant, Haematology, NHS Lothian

Dr Victoria Campbell is a Consultant Haematologist in NHS Lothian. After graduating from Imperial College, she rotated through a number of London teaching hospital before moving to Scotland. As a consultant, she has worked in both district general and teaching hospitals, affording her an understanding of the unique pressures within each care system. She is currently the Transplant Programme Director for SE Scotland, the largest autologous only centre in the UK, and set up their CART centre, the first within an autologous only centre within the UK. She has led the team to challenge current care models, setting up ambulatory and hub and spoke delivery models. She is the ATMP lead for the region. Alongside this she leads the Haematology trials unit including establishing the early phase unit; she is PI on >10 studies and recently took on her first CI role. She is passionate about improving patient care.

[Title of session: Advanced therapy trials in haematology](#)

Dr Jay Shetty



Consultant Paediatric Neurologist and NRS Clinician, Paediatric Neurosciences, NHS Lothian

Jay Shetty is a Consultant Paediatric Neurologist at the Royal Hospital for Children and Young People Edinburgh with expertise in Paediatric Epilepsy, Epilepsy surgery, Invasive Brain monitoring, Rare Genetic and Neuroinflammatory disorders. He chaired Childhood Epilepsy SIGN guideline and part of Scottish Paediatric Epilepsy Surgery Program.

Jay has been active in clinical research and secured NRS fellowship in 2015. His research focus is on studying outcome of Epilepsy through Data linkage studies and conducting clinical

trials in epilepsy and rare diseases. He has been a principal investigator for number of clinical trials and more recently for a gene therapy trial for Rett Syndrome. He is involved in digital innovation currently working on remote EEG monitoring and AI solutions for EEG in the community in collaboration with School of Engineering.

Jay is a research committee member of Royal College of Paediatrics and Child Health, British Paediatric Neurology Association, and an expert advisor for Connect4Children, a pan European clinical trial network for children.

Jay is Program Lead for Paediatric Undergraduate Teaching at Edinburgh Medical School and has Honorary Readership at the University of Edinburgh.

Title of session: *Advanced therapies*

Professor Suvankar Pal



Consultant Neurologist and Personal Chair of Neurodegenerative Disorders and Clinical Trials, Centre for Clinical Brain Sciences, University of Edinburgh

Suvankar Pal is Professor of Neurodegenerative Disorders and Clinical Trials and Consultant Neurologist. He is co-lead investigator of the UK wide innovative multi-arm multi-stage MND-SMART trial, the Scottish Motor Neuron Disease Register (CARE-MND), a Deputy Director at the Anne Rowling Clinic, and Co-Investigator at the UK Dementia Research Institute. His clinical and research interests are focused on improving outcomes for people with neurodegenerative disorders, including accelerating early and accurate diagnoses, evaluating atypical presentations, leading population-based disease registries for longitudinal deep clinical phenotyping, digital and wet lab biomarker development, and delivery of innovative clinical trials.

Title of session: *MND SMART: A UK platform for flexible, efficient, and definitive MND trials*

Chair 1
Tracey Gillies



Executive Medical Director, Medical Director's Office, NHS Lothian

Miss Gillies, who is a general surgeon, took up the Medical Director's post on 1 February 2017. Tracey spent a significant part of her career at NHS Lothian, before joining NHS Forth Valley in 2014.

In her role as Medical Director, Tracey is responsible for providing professional advice to the board and leadership to medical professionals, pharmacists, healthcare scientists and occupational health and safety staff across the Lothians.

She is also the Lead Director for medical workforce planning and the education and training of doctors to secure high-quality teaching and training in partnership with the University of Edinburgh Medical School and NHS Education Scotland.

Chair 2
Professor David Newby



Professor of Cardiology, Cardiology, University of Edinburgh

Professor David Newby is British Heart Foundation Duke of Edinburgh Chair of Cardiology at the University of Edinburgh, and a Consultant Interventional Cardiologist at Royal Infirmary of Edinburgh. He is Director of the Institute for Neuroscience and Cardiovascular Research, the British Heart Foundation Centre of Research Excellence and Edinburgh Imaging facilities. He has major interests in experimental medicine, advanced imaging and clinical trials of cardiovascular disease. He has led several multicentre clinical trials including the SCOT-HEART and SCOT-HEART 2 trials.

Chair 3
Professor Sarah Walmsley



Professor of Respiratory Medicine, University of Edinburgh

Sarah is a Professor of Respiratory Medicine, University of Edinburgh, Honorary Consultant Physician, NHS Lothian, Dean of Medical Research and a Director of the Edinburgh Clinical Academic Training Scheme. Sarah undertook her medical training at the University of Edinburgh graduating in 1997, and an MRC training fellowship at the University of Cambridge with award of her PhD in 2004. Sarah's specialist training in Respiratory Medicine was in Sheffield, where she also held a

Wellcome Intermediate Fellowship, prior to her move to Edinburgh as a Wellcome Senior Clinical Fellow. During this time, she had two periods of maternity leave. Sarah is currently based in the Centre for Inflammation Research in the Institute for Regeneration and Repair in Edinburgh. Sarah's work is focused on understanding how local oxygen and nutrient availability in the inflamed environment can reprogram neutrophil behaviour in both acute and chronic inflammatory lung disease states.

Chair 4 Scott Garden



Director of Pharmacy and Medicines, Pharmacy, NHS Lothian

Scott graduated from Robert Gordon University with a Master of Pharmacy honours degree in 1999. The early part of his career was spent working in Community Pharmacy before moving into the NHS in 2007 where he became the Site Lead Pharmacist for the Royal Infirmary Edinburgh.

In 2013 he moved to NHS Fife to undertake the role of Chief Pharmacist, Acute Services where he undertook a number of change programmes to transform both Pharmacy services and medicines governance across the organisation. During this time Scott continued to develop his clinical practice within Acute medicine where he successfully completed an MSc in Advanced Pharmacy Practice and qualified as an independent pharmacist prescriber.

In 2019 he became Executive Director of Pharmacy and Medicines for NHS Fife which encompassed both Pharmacy and wider system leadership responsibilities. In 2022 he re-joined NHS Lothian to take on the role of Director of Pharmacy and Medicines and has recently joined the NHS Lothian Corporate Management Team.

Scott is a fellow of the Royal Pharmaceutical Society and a Scottish Quality and Safety fellow. He has held University teaching and research commitments and is currently focused on putting Lothian at the forefront of developing Advanced Therapy Medicinal Products.

Abstract submission speaker
Dr Kathryn Hunt



**Clinical Research Fellow, Centre for Cardiovascular Science,
University of Edinburgh**

Kathryn is an MRC funded Clinical Research Fellow and second year PhD student within the Centre for Cardiovascular Science, supervised by Professor Rebecca Reynolds. Her research is focused on the role of vascular dysfunction in pregnancy complications including Pre-eclampsia, Fetal Growth Restriction and Stillbirth. In particular, she is investigating the potential of biomarkers from retinal imaging and cardiovascular models to identify individuals at risk of these conditions.

Title of session: [Revealing maternal vascular responses to pregnancy through the eye](#)

Abstract submission speaker
Prof Michael Eddleston



**Professor of Clinical Toxicology, CVS, The University of
Edinburgh**

Michael is a Professor of Clinical Toxicology at the University of Edinburgh, Honorary Consultant Physician and Pharmacologist at the Royal Infirmary of Edinburgh, and Clinical Lead for the UK National Poisons Information Service.

He trained in medicine at Cambridge and Oxford, completing a PhD at the Scripps Research Institute, La Jolla. While a medical student, Michael developed an interest in self-poisoning in rural Sri Lanka, leading to a year-long clinical trial and co-authoring the Oxford Handbook of Tropical Medicine. After basic medical training, he spent four years in Sri Lanka as a Wellcome Trust Career Development Fellow before completing specialist medical training in Edinburgh. Michael became a Senior Clinical Fellow and Consultant in 2009 and was appointed Professor in 2013.

Michael now leads an international research group focused on preventing deaths from acute poisoning while continuing clinical work at the Royal Infirmary of Edinburgh.

Title of session: [Treating drug overdose-related coma with intramuscular \(IM\) flumazenil: The RUFUS study](#)

Abstract submission speaker
Mr Konstantin Georgiev

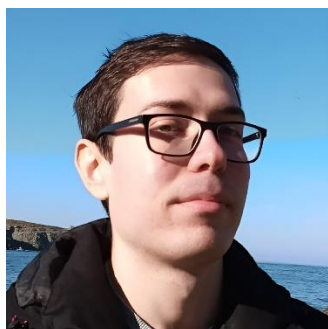

**PhD Student in Precision Medicine | Health Data Scientist,
Centre for Cardiovascular Science, University of Edinburgh |
NHS England**

Final-year PhD Student at the University of Edinburgh and Data Scientist at NHS England, with a background in AI and software engineering. His research focus is on harnessing routine healthcare data for care pathway analytics, risk prediction and improving resource allocation in older people. As part of my PhD, Konstantin, used health record data from NHS Lothian services to look at COVID-19 care patterns, dementia risk and multimorbidity. His current work is focused on predicting flexible endpoints using routine data that could determine nursing and rehabilitation care needs in urgently hospitalised patients.

Throughout the past 4 years, Konstantin has been involved with various projects as part of the Red Star team, working on digital healthcare pathways across NHS Scotland. He is particularly interested in methodologies covering explainable AI, machine learning and multimodal fusion, with a focus on geriatric care planning.

Title of session: [Harnessing Machine Learning to forecast inpatient care intensity for unscheduled admissions in NHS Lothian](#)

Abstract submission speaker
Dr Clark Russell



**ECAT Clinical Lecturer, Centre for Inflammation Research,
University of Edinburgh**

Clark Russell is an ECAT Clinical Lecturer in infectious diseases and microbiology. He works in the NHS Lothian infection service and in the University of Edinburgh Centre for Inflammation Research. He is interested in stratified medicine and host-directed therapies for gram-positive bacterial infections.

Title of session: [Patient stratification identifies differential treatment effects in Staphylococcus aureus bacteraemia](#)

Abstract submission speaker
Sandeep Ramalingam



Consultant Virologist, Laboratory Medicine, NHS Lothian

Sandeep came to the UK in 2002 having completed his medical, MD (Microbiology) and PhD (Virology) in India. He worked at Kings College Hospital and at the Colindale PHLS lab towards his FRCPath. Having done a stint at Sheffield, Sandeep joined NHS Lothian in 2009. His main interest these days are to try and reduce the burden of viral illness in the community. Towards this, he reported the presence of an antiviral mechanism in most cells in our body which uses chloride ions. He also reported the proof of principle pilot RCT of nasal irrigation and gargling with hypertonic saline in adults with the common cold. This study proved that we can use the chloride ion mediated antiviral mechanism to treat common viral infections. He is now presenting the results of a larger RCT of hypertonic saline nose drops in children with the common cold.

Title of session: A randomised controlled trial of homemade hypertonic saline nose drops to treat children with upper respiratory tract infection: ELVIS-Kids

Poster abstract list

Poster can be viewed from the Prestonfield room

Poster Number	Abstract Title	Person presenting poster on the day
1	Harms with placebo in trials of biological therapies and small molecules as induction therapy in inflammatory bowel disease: a systematic review and meta-analysis	Shahida Din
2	Gut instincts and data insights: using Predictive Laboratory markers for IBD to optimise colonoscopy triage	Shahida Din (Primary Authors: Danial Imseeh and Shahida Din)
3	Lessons learned from the development and implementation of a shared decision-making process for severe stroke using a digital communication platform	Akila Visvanathan
4	IBD Associated Colorectal Cancer: chemopreventive effects of 5-ASAs, Immunomodulators, and Biologics	Amirhosein Kefayat
5	A large brain imaging dataset for dementia research: a Scottish Medical Imaging (SMI) cohort	Maria Valdes Hernandez (Primary Author: Michael Camilleri)
6	Single machine learning classifier to detect EEG signals from clinical dataset- Digital Innovation for early diagnosis of epilepsy and potential biomarker for clinical trials	Bartlomiej Chybowski (Primary Author: Jay Shetty)
7	Patient and Public Involvement and engagement for digital innovation to improve Infantile Spasms Syndrome diagnosis	Iva Peh
8	Outcomes of Early Childhood Epilepsy: a Scottish population-based study	Jemima Alston
9	PET/MRI to improve staging and personalise treatment for prostate cancer: PRISTINE study interim results	Rishi Ramaesh (Primary Author: Robert Cronshaw)
10	Assessing the feasibility of Cone Beam CT soft tissue matching to the urethra during prostate SBRT	Joanne Mitchell

11	Platform study for intracerebral haemorrhage (plinth): feasibility of a proportionate approach to consent in platform trial recruitment	Allan MacRaild
12	Cognitive empathy differences on the Questionnaire of Cognitive and Affective Empathy (QCAE) distinguish between borderline personality disorder (BPD) and other mental disorders.	David Hayward
13	Acceptability of a digital health intervention (DHI) to inform women about postpartum contraception	Michelle Cooper
14	Scoping survey of postpartum contraception (PPC) provision across Europe	Michelle Cooper
15	Is length of stay in the Emergency Department (ED) associated with delirium during index hospitalisation?	Victoria Minnis
16	Bridging research and clinical care: a survey of Emergency Department staff perceptions	Malgorzata D. Litwin
17	Validation of a novel tool for assessing insight into symptoms of dementia.	Catherine Pennington
18	Creating a clinical research companion guide for Parkinson's	Gordon Duncan and Jess Crossan
19	CLOVA Trial "CLOVe oil for fissure in Ano"	Doug Speake
20	DataLoch: supporting the responsible and secure use of data to improve health and social care	Pamela Linksted
21	Early detection of deteriorating surgical patients with Enhanced Monitoring Using Sensors (EMUs)	Afra Jiwa and Malcolm Cameron
22	Is the SNAP trial enrolling a representative cohort of patients with Staphylococcus aureus bacteraemia in NHS Lothian?	Angus McCance
23	Outcomes of Focal Epilepsy in children and young people - Scottish regional population study	Emily Lancaster
24	Routine evaluation of people living with cancer	Michael Yule (Primary Authors: Michael Yule, Cathleen Grossart)
25	Total versus robotic-assisted unicompartmental knee replacement (TRAKER) for medial compartment steorthritis: a randomised controlled trial	Eliott Martinson
26	Circulating blood matrix metalloproteinase (MMP)-10 and 12 can accurately predict mucosal healing in Inflammatory Bowel Disease (IBD) in a multi-centred prospective longitudinal cohort study (2020-2024).	Peter Cartlidge

27	Quantitative faecal immunohistochemical test (qFIT) is a comparable and 'greener' alternative to faecal calprotectin (fCal) in IBD	Peter Cartlidge
28	PET-based fibrosis scanning in Crohn's disease: A novel imaging human experimental approach to detect and quantify fibrosis activity burden in structuring Crohn's disease (FATE-CD)	Solomon Ong
29	Developing the Edinburgh Mood Disorders Research Clinic	Alasdair Rooney
30	Developing Practice learning opportunities in clinical research nursing and midwifery	Amy McLaren
31	Permission to contact development of a research registry	Tallulah Armstrong (Primary Author: Amy Shepherd)
32	Overcoming barriers: enhancing recruitment for vaccine research in the older population	Louise Sharp
33	How do you manage the BIG problem of small babies?	Roseanna Jenks
34	NHS Lothian pioneers the first partial gland treatment for prostate cancer in Scotland	Katie Power and Sarah Gallen
35	GPs' experience of embedded Musculoskeletal advanced practice Physiotherapists in Primary Care: a cross-sectional survey with content analysis.	Jordan Hepburn
36	Supporting prescriber progression: a participatory mixed-method approach using group concept mapping	Caroline Souter
37	Improving access to assistive living technologies in the community	Sarah Sutton
38	Beneficial effect of autologous macrophage therapy on clinical outcomes in patients with compensated cirrhosis: extended follow up data from a randomised controlled phase 2 trial.	Alison Glover (Primary Author: Paul N Brennan)
39	Clinical trial recruitment: a partnership success story	Gill Scott (Primary Authors: Morag Place, Hannah Rickman, Rebecca Skillen, Gill Scott)

40	SCOT-HEART2 IMPACT study: impact of CT coronary angiography on lifestyle modification and preventative therapy in the primary prevention of myocardial infarction	Hannah Rickman (Primary Authors: Bev Goldberg, Hannah Rickman, Joanne Ross and Dawn Shepherd)
41	An exploration of experiences of people with lived experiences of COPD in the Lothians, particularly in underserved communities.	Sammy Waite
42	The AIRGLOVE: The best way to support cannulation in cancer patients	Heather McVicars
43	Routine evaluation of people living with cancer (REVOLUTION) – surgery (IRAS: 311387)	Cathleen M. Grossart
44	Improved glycaemic profile and diabetes distress in 30 people with type 1 diabetes after commencing hybrid closed loop system.	Ashton McGregor (Primary Author: John A. McKnight)

Exhibitors

Exhibitors will be based in the Concourse.

Click on each logo to visit the exhibitors' websites.

Exhibitor 1	
 NHS Lothian Charity Making healthcare better, together	 @nhslothcharity
Exhibitor 2	
 InnoScot Health	 @innoscothealth  @innoscothealth.bsky.social
Exhibitor 3	
 SHARE Recruiting for Research, Improving our Health	 @register4share
Exhibitor 4	
 ECTU Edinburgh Clinical Trials Unit	
Exhibitor 5	
 Northern Alliance Advanced Therapies Treatment Centre	 CATAPULT Cell and Gene Therapy
Exhibitor 6	
 health innovation South East Scotland	 @hises_scotland  https://www.linkedin.com/company/hises/